

95° aluminium frame door hinge

Web code  
DQDMBY

**Planning**

Hinge dimensions and gap calculation based on factory setting (mounting plate spacing = 0 mm)

Hinge and front protrusion at full opening angle

**Overlay application**

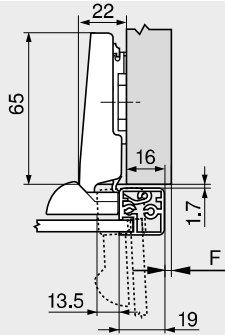
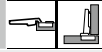

F Gap

**Dual application**

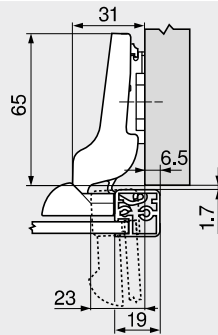
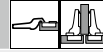

**Inset application**

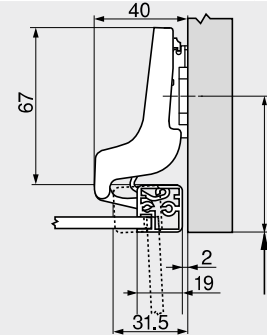
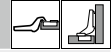

Set mounting plate back by frame width +1.7 mm

**Minimum gap F for aluminium frame fronts (R = 1 mm) based on the factory setting**

Side frame width RB (mm)	Frame thickness RS (mm)											
	18	19	20	21	22	24	25	26	27	28	30	32
19	0.2	0.3	0.4	0.6	0.7	1.2	Δ	Δ	Δ	Δ	Δ	Δ
20	0.2	0.3	0.4	0.5	0.7	1.1	Δ	Δ	Δ	Δ	Δ	Δ
21	0.2	0.3	0.4	0.5	0.7	1.0	Δ	Δ	Δ	Δ	Δ	Δ
22	0.2	0.3	0.4	0.5	0.7	1.1	Δ	Δ	Δ	Δ	Δ	Δ
<b>Additional for +2 mm side adjustment</b>												
	+0.1	+0.2	+0.3	+0.3	+0.3	+0.4						

Δ In these cases a trial is recommended

**Adjustment**

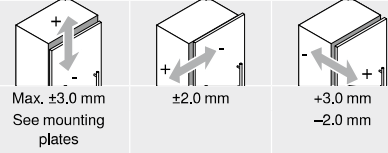

**Screw-on**

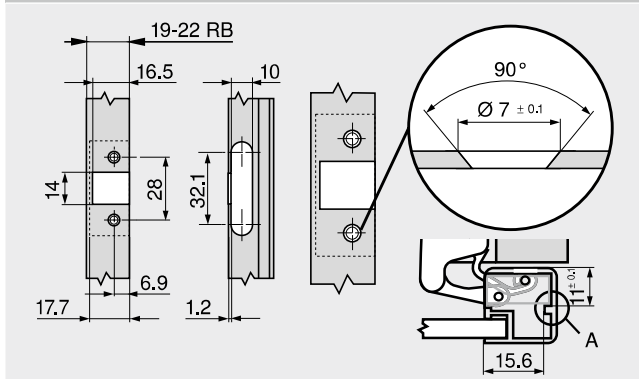

RB Side frame width  
A The hinge boss should be able to support itself in the routing

**Reference pages**

Overview	71	Assembly, removal and adjustment
Mounting plates	144	
Accessories – Hinge arm cover cap	151	
Accessories – General	153	Short URL
BLUMOTION for doors	156	<a href="http://www.blum.com/a210">www.blum.com/a210</a>
TIP-ON for doors	170	
E-SERVICES and assembly devices	590	
More technical details	698	

